

Make a leaf-print Flower Pot Bird House

Why not have a go at making this flower pot birdhouse - see if you can tempt some of our feathered friends to set up home in one of these camouflage-painted, leaf-printed birdhouses!

You will need...

- flowerpot
- nail scissors
- larger scissors
- ruler
- duct tape
- permanent marker pen
- plastic lid from chocolate or biscuit box
- tester paint pot / matt paint or acrylic paints
- paintbrush
- crayons or oil pastels
- leaves
- scouring pad
- old toothbrush



Step 1: Place the pot, or a pot of the same size, face down on the plastic box lid, and draw around it using a permanent marker pen. Ask an adult to help cut the circle out; you'll need decent scissors for this.

Next, measure up from the edge of the circle by at least 10cm. The entrance hole needs to be at least 10cm up from the circle edge (12.5cm is even better) to deter predators - try to use a larger pot if you can so that this is possible.

Next, measure and mark out the entrance hole using permanent marker pen. To attract small birds such as bluetits, cut an entrance hole with a diameter of 2.5cm; for great tits 2.8cm; for house sparrows 3.2cm and for starlings 4.5cm. When completed,

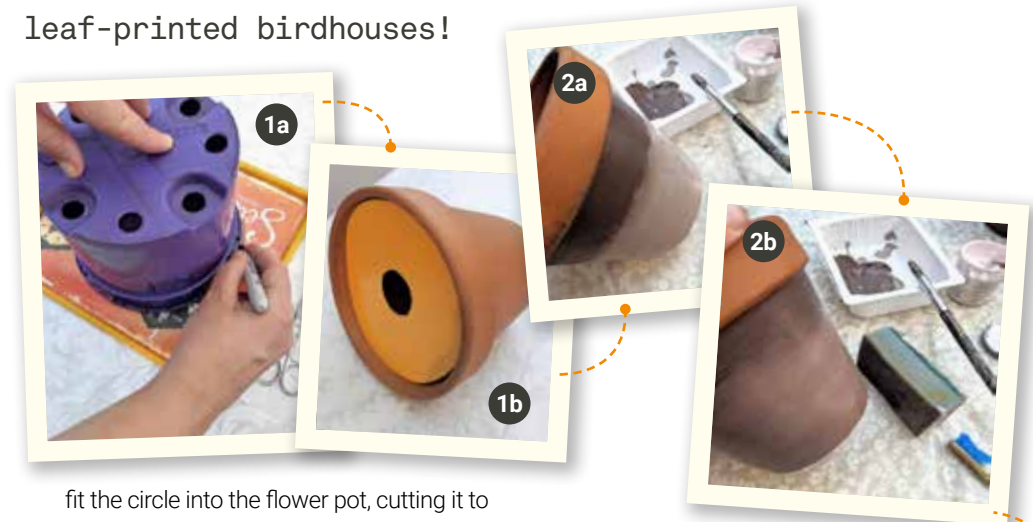

fit the circle into the flower pot, cutting it to fit carefully so that it fits securely and not loosely. If necessary you can secure the lid in place with maximum strength duct or gaffa tape later on, once you have placed the bird box securely in its final location.

Step 2: Paint bands of colour, using old tester pots or acrylic paint, then blend them into each other using the scouring pad. Apply several layers of paint, and blend them in.

Try using an old toothbrush to make interesting marks and patterns. Think about what colours you use - what colours do

we see in nature? Where are you thinking of placing your birdbox, what colours are there that you can add

Eginblanhigion
tŷ pawb
Seedlings

Make a leaf-print Flower Pot Bird House

to your birdbox so that it will blend in with its surroundings? What else can you find that might be good for making different marks and patterns? Don't worry about 'making mistakes' as there is no right or wrong way of doing this. Just have fun!

Step 3: Paint the backs of the leaves with a thin layer of paint (no water) and place the painted-side of the leaf down against the pot.

Press lightly, lift, and repeat. If you like, you can practice on a piece of paper first to get any excess paint off, and then print onto the birdhouse. You could also place a leaf on the pot and sponge over it lightly with a little paint on the scouring pad (no water) then lift the leaf off, leaving a negative-space leaf print. Think about layering the leaf prints, and using several different colours.

You could print over the same area twice, or place the leaf slightly 'off focus' the second time, to get a layered effect and create depth. Or you could use two different colours on top of each other, or overlapped, to create texture and depth.

Step 4: Next paint the plastic circle, using the paintbrush, toothbrush and scouring pad.

Remember - think camouflage! Add layers and depth. The aim is for your birdhouse to blend in with its surroundings. Don't be scared to really go for it - remember there is no right or wrong

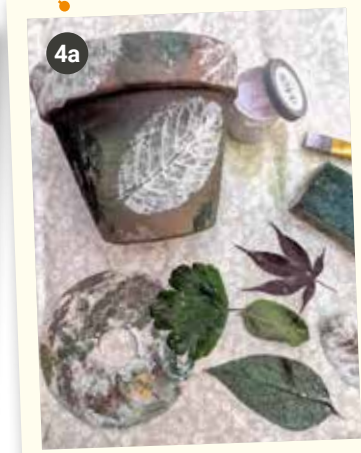
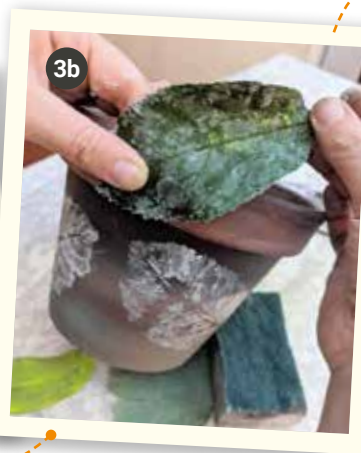
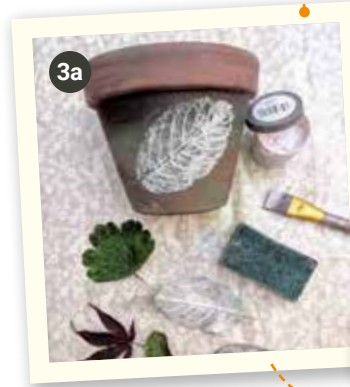

way to do this, just have fun! You can also use crayons or oil pastels. Don't worry too much about how it looks, just enjoy painting, printing, experimenting and making lots of different marks! Keep adding layers - be brave and experiment!

Hanging your bird house

You are now ready to hang your birdhouse. Ask an adult to help you with this. Birdboxes are best placed facing between north and east to avoid strong sunlight and the wettest winds. Find a sheltered and protected spot. Make sure that you attach your birdbox very securely and at least 2m off the ground, if not higher. Some birds, like robins, do like to nest lower down - and have been known to make their homes in watering cans, teapots and even old wellies!



Make sure that you position your birdbox in a safe space away from potential predators. This birdbox can be securely attached to a wall or fence by removing the circular cover for a minute and using a screw or nut and bolt

through the drainage hole in the base of the pot. Please ask an adult for help with this.

If attaching the birdbox to a tree it is better to find an alternative way of attaching the birdbox to the trunk, rather than a nail which could damage the tree. Make sure to check the box fixings regularly to make sure that they are secure - except during nesting season when nesting birds like to be left alone!

It's a good idea to clean your bird house out every year once any inhabitants have flown the

nest, and remember you might not just attract birds - insects often like to live in bird boxes too! This isn't a bad thing - think of it as being like a spare hotel room, it's better to have a visitor than for the room to stay empty, and it all helps encourage wildlife to make their home in the garden!

Finally, If you have enjoyed this activity why not find out more information about garden birds and where they like to nest? There is lots of information online about garden birds, and lots more to find out!



Gwneud Blwch Adar print dail allan o Bot Blodau

Beth am roi cynnig ar wneud y blwch adar hwn allan o bot blodau - tybed fedrwy chi demtio rhai o'n ffrindiau pluog i sefydlu cartref yn un o'r blychau adar cuddliw print dail hyn!

Bydd angen arnoch...

- pot blodau • siswrn ewinedd • siswrn mwy
- pren mesur • tâp selio • pen marcio parhaol
- caead plastig bocsiocled neu fisgedi
- pot paent profi / paent matt neu baent acrylig
- brws paent • creonau neu basteli olew • dail
- pad sgwrio • hen frws dannedd



Cam 1: Rhowch y pot, neu bot o'r un maint, wyneb i lawr ar gaead y blwch plastig, a thynnu llinell o'i gwmpas gan ddefnyddio pen marcio parhaol. Gofynnwch i oedolyn eich helpu i dorri'r cylch allan; bydd angen siswrn call arnoch ar gyfer hyn.

Nesaf, mesurwch i fyny o ymyl y cylch gan o leiaf 10cm. Mae angen i'r twll mynediad fod o leiaf 10cm i fyny o ymyl y cylch (mae 12.5cm hyd yn oed yn well) i atal ysglyfaethwyr - ceisiwch ddefnyddio pot mwy os gallwch chi fel bod hyn yn bosibl.

Nesaf, mesurwch a marcio'r twll mynediad gan ddefnyddio pen marcio parhaol. Er mwyn denu adar bach fel y titw tomos las, torrwrch dwll mynediad â diamedr o 2.5cm; ar gyfer y titw mawr 2.8cm; ar gyfer adar y to 3.2cm ac ar gyfer

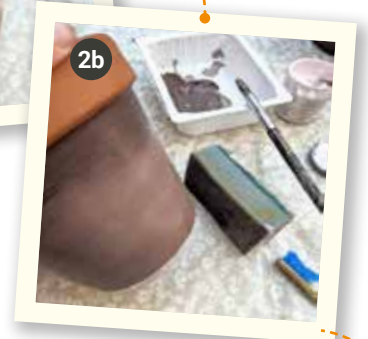
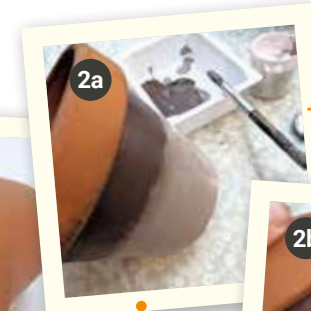
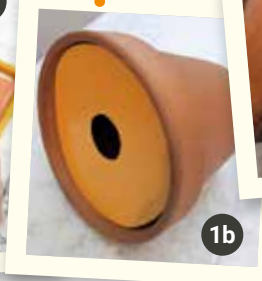

drudwy 4.5cm. Ar ôl ei gwblhau, gosodwch y cylch yn y pot blodau, gan ei dorri i ffitio'n ofalus fel ei fod yn ffitio'n gadarn ac nid yn rhydd. Os oes angen, gallwch ddiogelu'r caead yn ei le gyda'r tâp selio neu dâp gaffa yn nes ymlaen, unwaith y byddwch wedi gosod y blwch adar yn ddiogel yn ei leoliad terfynol.

Cam 2: Paentiwch fandiau o liw, gan ddefnyddio hen botiau profi neu baent acrylig, yna eu cymysgu â'i gilydd gan ddefnyddio'r pad sgwrio. Rhowch sawl haen o baent, a'u cymysgu i mewn.

Rhowch gynnig ar ddefnyddio hen frws dannedd i wneud marciau a phatrymau diddorol.

Meddyliwch pa liwiau rydych chi'n eu defnyddio - pa liwiau rydyn ni'n eu gweld ym myd natur? Ble ydych chi'n ystyried gosod eich blwch adar, pa

Eginblan higion
tŷ pawb
Seedlings

Gwneud Blwch Adar print dail allan o Bot Blodau

liwiau sydd yna y gallwch chi eu hychwanegu at eich blwch adar fel y bydd yn cyd-fynd â'r hyn sydd o'i gwmpas? Beth arall allwch chi ddod o hyd iddo a allai fod yn dda ar gyfer gwneud marciau a phatrymau gwahanol? Peidiwch â phoeni am 'wneud camgymeriadau' gan nad oes ffordd gywir nac anghywir o wneud hyn. Dim ond cael hwyl wrth wneud!

Cam 3: Paentiwch gefnau'r dail gyda haen denau o baent (dim dŵr) a gosod ochr baentiedig y ddeilen i lawr yn erbyn y pot.

Pwyswch yn ysgafn, ei godi, ac ailadrodd y broses. Os dymunwch, gallwch ymarfer ar ddarn o bapur yn gyntaf i gael unrhyw baent gormodol i ffwrdd, ac yna printio ar y blwch adar. Fe allech chi hefyd roi deilen ar y pot a rhoi sbwng drosti yn ysgafn gydag ychydig o baent ar y pad sgwrio (dim dŵr) yna codi'r ddeilen i ffwrdd, gan adael lle gwag siâp deilen.

Meddyliwch am haenu'r printiau dail, a defnyddio sawl lliw gwahanol. Fe allech chi argraffu dros yr un ardal ddwywaith, neu osod y ddeilen ychydig yn 'sgiw-wiff' yr eildro, i gael effaith haenog a chreu dyfnder. Neu fe allech chi ddefnyddio dau liw gwahanol ar ben ei gilydd, neu orgyffwrdd, i greu gwedd a dyfnder.

Cam 4: Yna paentiwch y cylch plastig, gan ddefnyddio'r brws paent, y brws dannedd a'r pad sgwrio.

Cofiwch - meddyliwch am y cudd-liw! Ychwanegwch haenau a dyfnder. Y nod yw i'ch

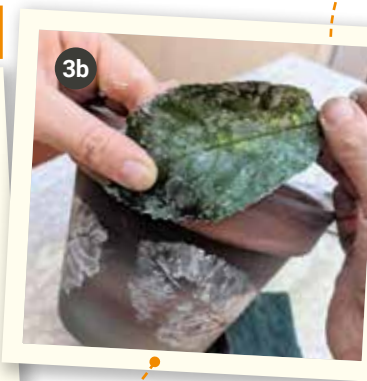
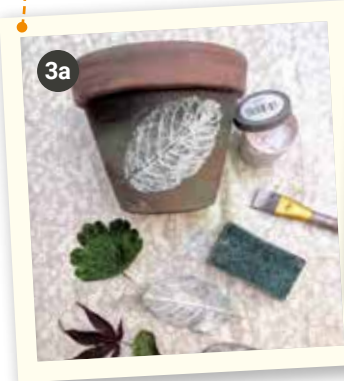

blwch adar gydweddu â'r hyn sydd o'i gwmpas. Peidiwch â bod ofn mynd amdani go iawn - cofiwch nad oes ffordd gywir nac anghywir o wneud hyn, dim ond cael hwyl!

Gallwch hefyd ddefnyddio creonau neu basteli olew. Peidiwch â phoeni gormod am sut maen' edrych, dim ond mwynhau paentio, argraffu, arbrofi a gwneud llawer o wahanol farciau! Dalwch ati i ychwanegu haenau - byddwch yn ddewr ac arbrofwch!

Hongian eich blwch adar

Rydych nawr yn barod i hongian eich blwch adar. Gofynnwch i oedolyn eich helpu gyda hyn. Mae blychau adar yn y sefyllfa orau yn wynebu rhwng y gogledd a'r dwyrain er mwyn osgoi golau haul cryf a'r gwyntoedd gwlypaf. Dewch o hyd i le cysgodol a gwarchoddedig. Gwnewch yn siŵr eich bod chi'n atodi'ch blwch adar yn ddiogel iawn ac o leiaf 2m oddi ar



y ddaear, os nad yn uwch. Mae rhai adar, fel robin goch, yn hoffi nythu yn is i lawr - ac fe wyddys eu bod yn gwneud eu cartrefi mewn caniau dyfrio, tebotau a hyd yn oed hen esgidiau glaw! Gwnewch yn siŵr eich bod chi'n gosod eich blwch adar mewn man diogel i ffwrdd oddi wrth ysglyfaethwyr posibl. Gellir cysylltu'r blwch adar hwn yn ddiogel â wal neu ffens trwy dynnu'r gorchudd crwn am funud a defnyddio sgrir neu nyten a bollt trwy'r twll draenio yng ngwaelod y pot. Gofynnwch i oedolyn am help gyda hyn.

Os ydych chi'n cysylltu'r blwch adar â choeden maen' well dod o hyd i ffordd arall o atodi'r blwch adar i'r bonyn, yn hytrach na hoelen a allai niweidio'r goeden. Gwnewch yn siŵr eich bod yn gwirio ffitiadau'r bocs yn rheolaidd i sicrhau eu bod yn ddiogel - ac eithrio yn ystod y tymor nythu pan fydd adar sy'n nythu yn hoffi cael eu gadael ar eu pennau eu hunain! Mae'n syniad da glanhau'ch

blwch adar bob blwyddyn unwaith y bydd unrhyw breswylwyr wedi hedfan

yn nyth, a chofiwch efallai nad ydych chi'n denu adar yn unig - mae pryfed yn aml yn hoffi byw mewn blychau adar hefyd! Nid yw hyn yn beth drwg - meddyliwch amdano fel bod ag ystafell westy sbâr, maen' well cael ymwelydd nag i'r ystafell aros yn wag, ac maen' cyfan yn helpu i annog bywyd gwylt i wneud eu cartref yn yr ardd!

Yn olaf, os ydych chi wedi mwynhau'r gweithgaredd hwn beth am ddarganfod mwy o wybodaeth am adar gardd a ble maen nhw'n hoffi nythu? Mae yna lawer o wybodaeth ar-lein am adar gardd, a llawer mwy i'w ddarganfod!

